

# Punto Pruszyński Sp. z o.o.

SUFIT OTWARTY z paneli S/84 na trawersynie T/90

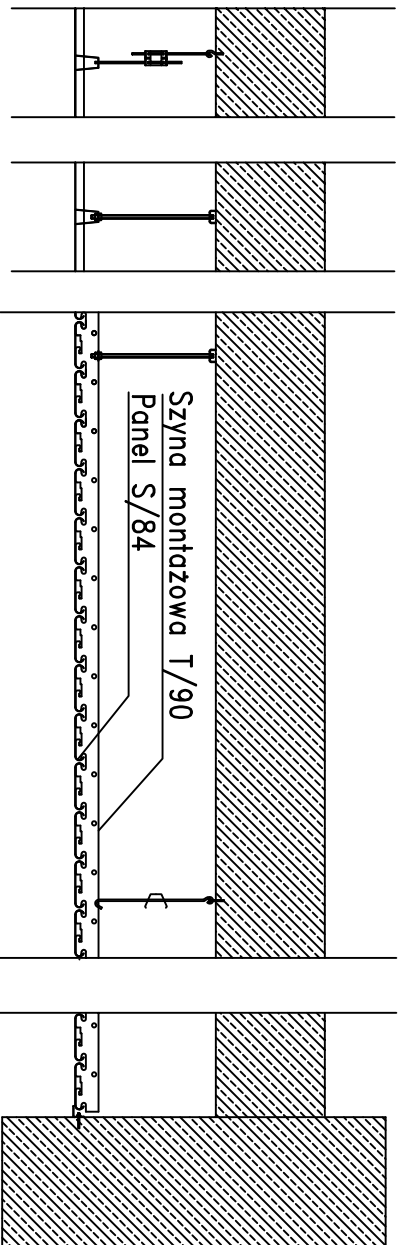

Panel S/84

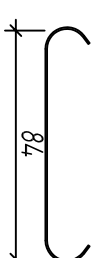

MATERIAŁ	GRUBOŚĆ		
	0,5	0,6	0,7
ALUMINIUM	+	+	+
STAL	-	-	-

Możliwość perforacji paneli ŚREDNICA 2mm 22%

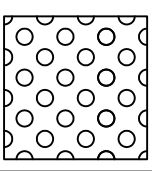

Elementy dodatkowe

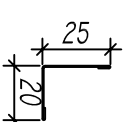

Katownik Sc/2

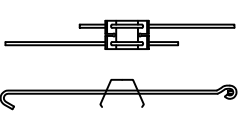

Wieszak do stosowania wewnątrz pomieszczeń

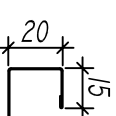

Ceownik Sc/3

Szyrna montażowa – T/90

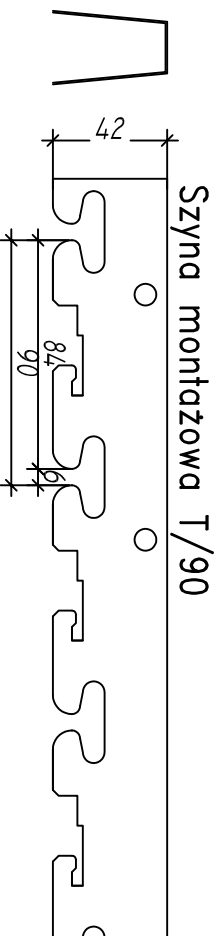

MATERIAŁ

STAL

ALUMINIUM

	+	-
STAL	+	+
ALUMINIUM	+	+