

Punto Pruszyński Sp. z o.o.

SUFITY RASTROWE "Open Cell" na konstrukcji T 24

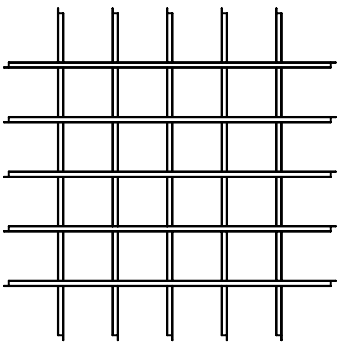

Element 600x600
bez ramki

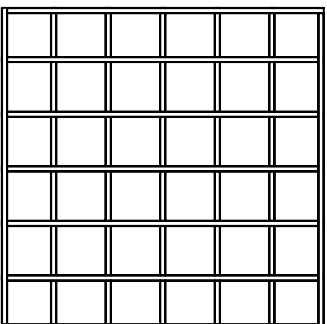

Element 600x600
z ramką

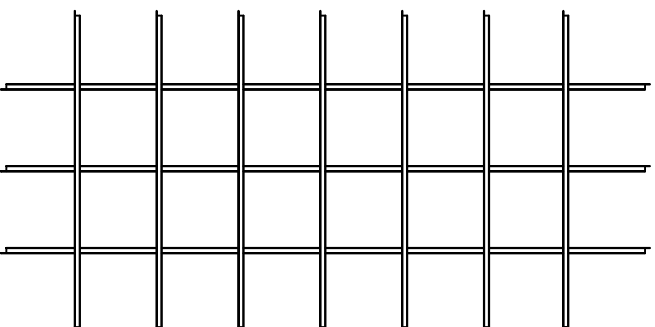

Element 600x1200
bez ramki

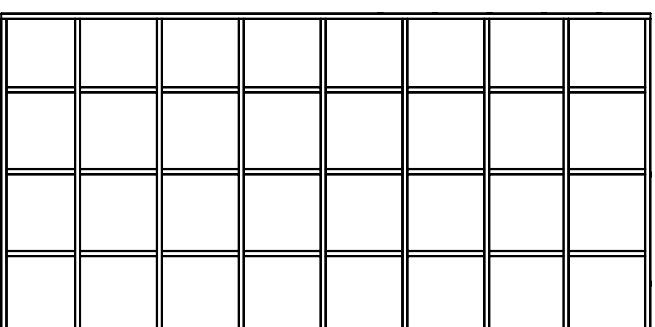

Element 600x1200
z ramką

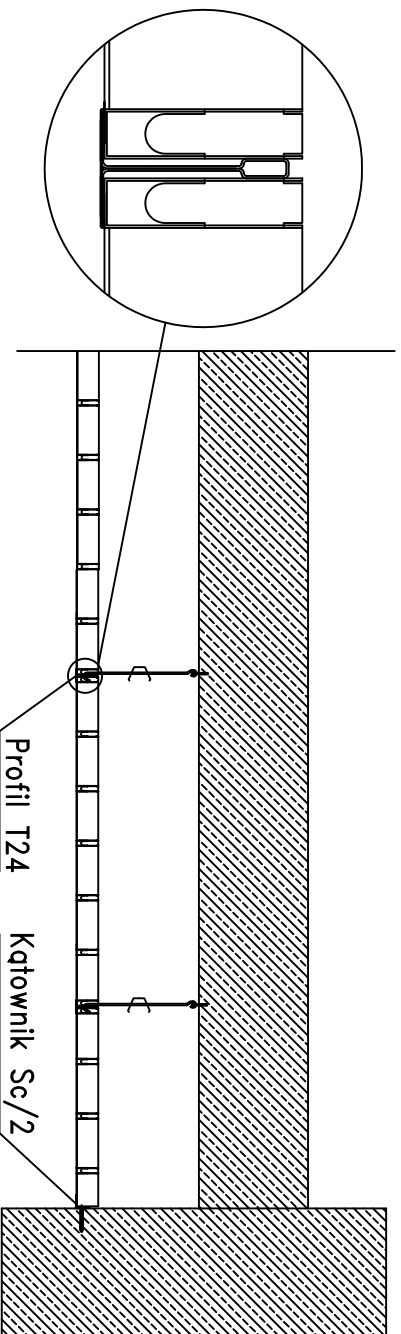

Przekrój elementów rastra

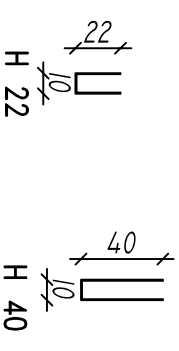

Rozmiary oczek

50 60 75 86
100 120 150 200

Elementy dodatkowe

Konstrukcja T24 Katownik Sc/2

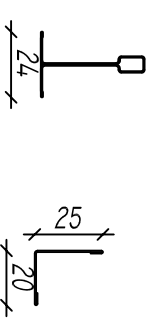

Wieszak

